

PE388B



Features :

- 1-10V dimmer, dimming soft and smoothly
- Support to turn off the driver input power
- Glass panel, metal knob with strong texture
- Super dimming compatibility
- Slow light and slow off function
- Dimming range 0-100%
- Over heating protection
- Five years warranty

RoHS CE

General description:

PE388B dimmer is a 1-10V dimming control dimmer developed by our company. It adopts glass panel, metal knob, smooth dimming and simple operation

Specification:

	Model	PE388B
OUTPUT	Working Voltage	90-250Vac
	Load Power	500W Max
	Dimming function	1-10V double singal
	Max control signal	50MA
INPUT	Input Voltage range	90-250Vac
	Input power	<2W
	Frequency	50/60Hz
	control mode	dimming/ on and off
	remote control	
ENVIRONMENT	Working Temperature	ta: 45°C tc: 85°C
	Working Humidity	20 ~ 95%RH, non-condensing
	Storage temp., Humidity	-40 ~ 80 °C , 10~95%RH
	Waterproof grade	IP20
PROTECTION	Over Load Protection	Use within the specified load range
	Short Circuit Protection	The output cannot be short circuited, otherwise the dimmer will be damaged and cannot be repaired
	Non-Load Protection	constant voltage output when non-load
OTHERS	Dimension	86×86mm(L×W)
	Packing	100×92×62mm(L×W×H)
	Weight(G.W.)	158±10g

Dimension:

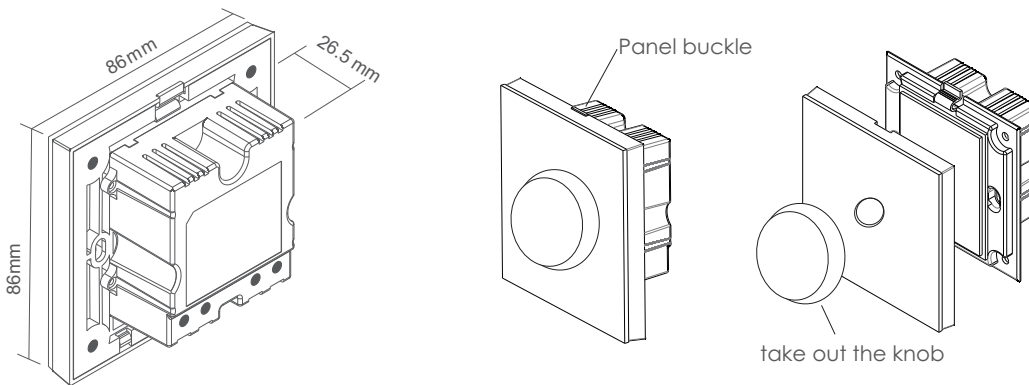

Product Label:

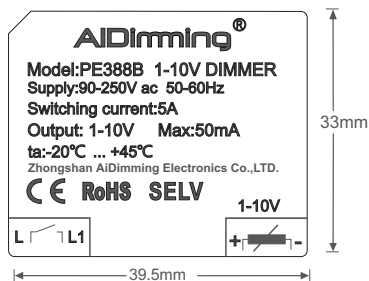

**Wiring Diagram:**

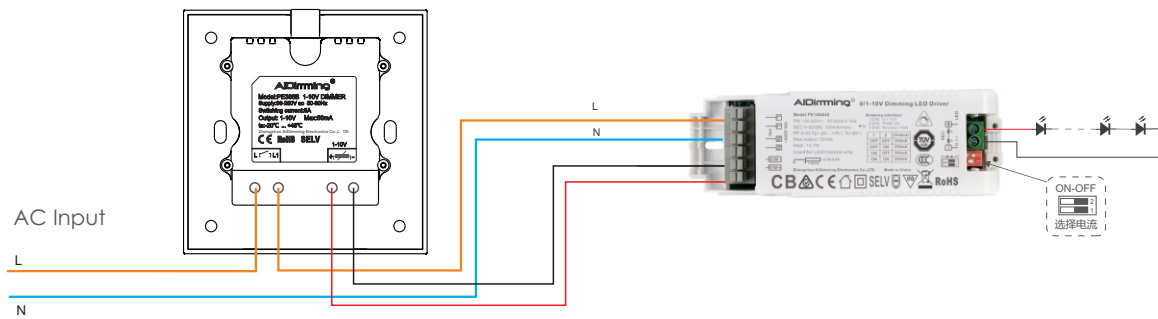

**usage method:**

1. 0-10v function: the interface of 0-10V dimmer is divided into positive and negative
2. Do not connect voltage higher than 10V at 0-10V interface
3. Rotate clockwise to increase the brightness.
4. The brightness decreases when it is rotated anticlockwise.

**Installation:**

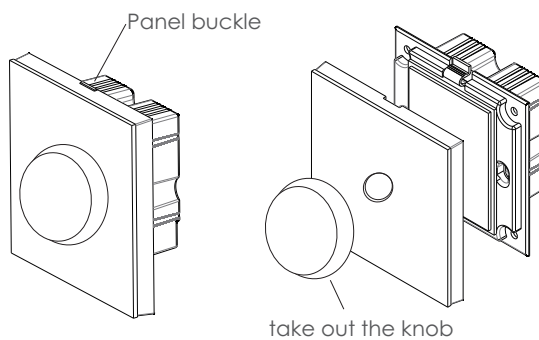

**The use of guidance:**

- Note:
- ★★Note 1. When using this dimmer, please distinguish the input end and output end, and power on only after checking;
  - ★★Note 2. Please connect the dimming driver of the output terminal and then connect the input wire, confirm it is correct, and then power on;
  - ★★Note 3. The input voltage range of the product is AC90-250V, the output power is within the specified use range, and the use ambient temperature is - 20 to + 45 °C. If the input voltage is 90V, the power will be halved;
  - ★★Note 4. The output of dimmer shall not be short circuited, otherwise the dimmer will be damaged;
  - ★★Note 5. Please connect the DIM and CCT signal correct;
  - ★★Note 6. The internal part of the product is alternating current. Please operate according to the specification with certificate;

**Statement :**

The pictures and specifications is for reference only, in kind prevail, specifications are subject to change with further notice.